

DATA SHEET



Three Phase Induction Motor - Squirrel Cage

Customer :						
Product line		: W22 Brake Motor NEMA Premium Efficiency Three-Phase		Product code :		14679747
Frame	:	324/6TC		Locked rotor time	:	36s (cold) 20s (hot)
Output	:	40 HP (30 kW)		Temperature rise	:	80 K
Frequency	:	60 Hz		Duty cycle	:	Cont.(S1)
Rated voltage	:	575 V		Ambient temperature	:	-20°C to +40°C
Poles	:	4		Altitude	:	1000 m.a.s.l.
Rated current	:	37.7 A		Protection degree	:	IP55
	:	6.1x(Code G)		Cooling method	:	IC411 - TEFC
Rated speed	:	1775 rpm		Mounting	:	F-1
Rated torque	:	16.4 kgfm		Rotation ¹	:	Both (CW and CCW)
Insulation class	:	F		Noise level ²	:	66.0 dB(A)
Service factor	:	1.25		Starting method	:	Direct On Line
Moment of inertia (J)	:	0.3861 kgm ²		Approx. weight ³	:	308 kg
Design	:	B				
Output	25%	50%	75%	100%	Foundation loads	
Efficiency (%)	0.000	93.6	94.1	94.1	Max. traction	: 340 kgf
Power Factor	0.00	0.72	0.80	0.85	Max. compression	: 648 kgf
Losses at normative operating points (speed;torque), in percentage of rated output power						
P1 (0,9;1,0)	P2 (0,5;1,0)	P3 (0,25;1,0)	P4 (0,9;0,5)	P5 (0,5;0,5)	P6 (0,5;0,25)	P7 (0,25;0,25)
6.2	5.4	4.9	2.8	2.0	1.3	0.9
		<u>Drive end</u>		<u>Non drive end</u>		
Bearing type	:	6312 C3		6212 C3		
Sealing	:	V'Ring		Lip Seal		
Lubrication interval	:	20000 h		20000 h		
Lubricant amount	:	21 g		13 g		
Lubricant type	:	Mobil Polyrex EM				
Notes						
This revision replaces and cancel the previous one, which must be eliminated. (1) Looking the motor from the shaft end. (2) Measured at 1m and with tolerance of +3dB(A). (3) Approximate weight subject to changes after manufacturing process. (4) At 100% of full load.				These are average values based on tests with sinusoidal power supply, subject to the tolerances stipulated in NEMA MG-1.		
Rev.	Changes Summary			Performed	Checked	Date
Performed by						
Checked by					Page	Revision
Date	12/05/2026				1 / 3	

DATA SHEET

Three Phase Induction Motor - Squirrel Cage



Customer : _____

Brake information

Voltage: 525-575 V
Brake Torque: 40.8 kgfm

Rev.	Changes Summary	Performed	Checked	Date
Performed by				
Checked by				
Date	12/05/2026		Page 2 / 3	Revision

LOAD PERFORMANCE CURVE

Three Phase Induction Motor - Squirrel Cage



Customer :

Product line : W22 Brake Motor NEMA Premium Efficiency Three-Phase Product code : 14679747

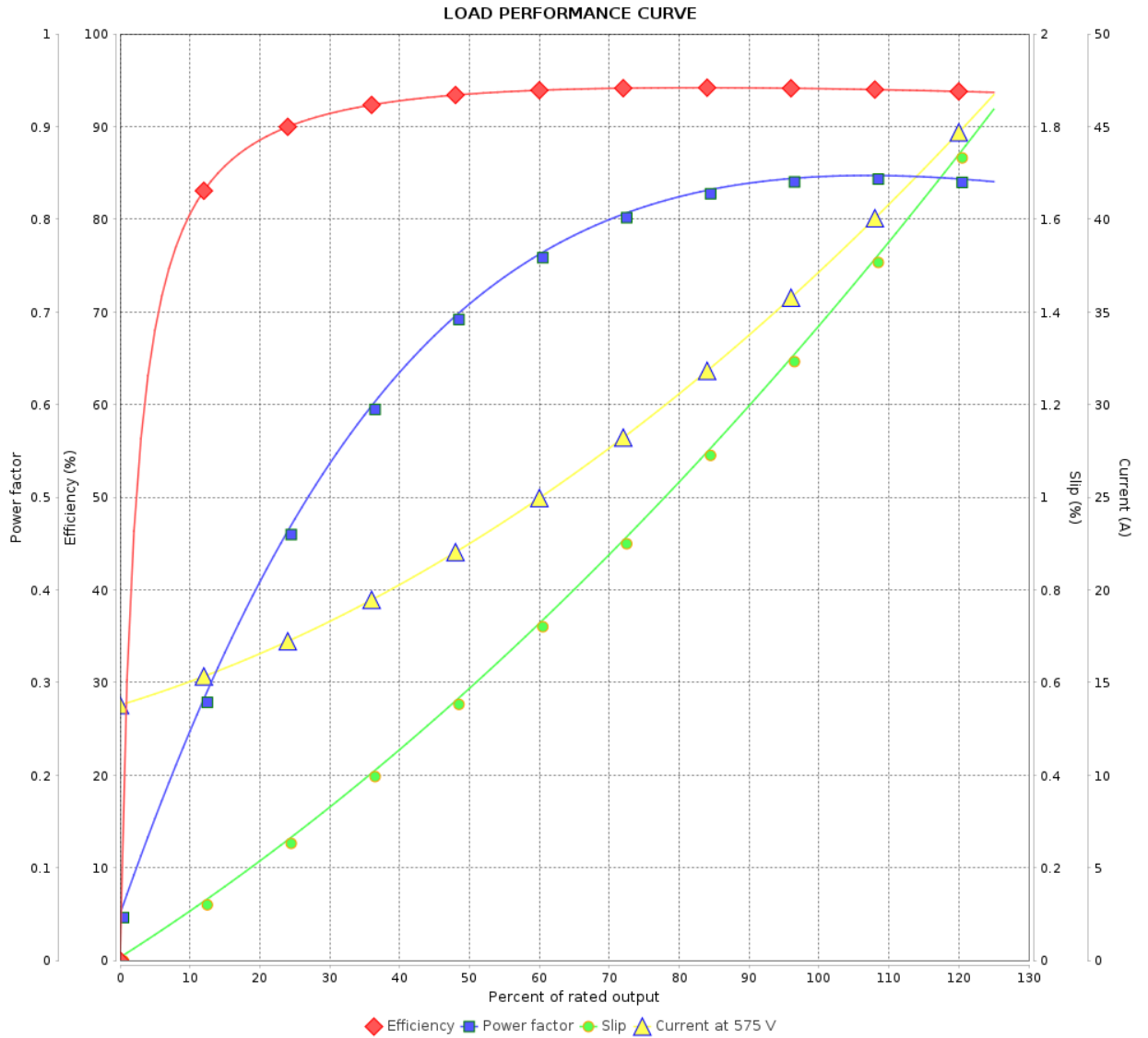

Rev.	Changes Summary	Performed	Checked	Date
Performed by			Page 3 / 3	Revision
Checked by				
Date				

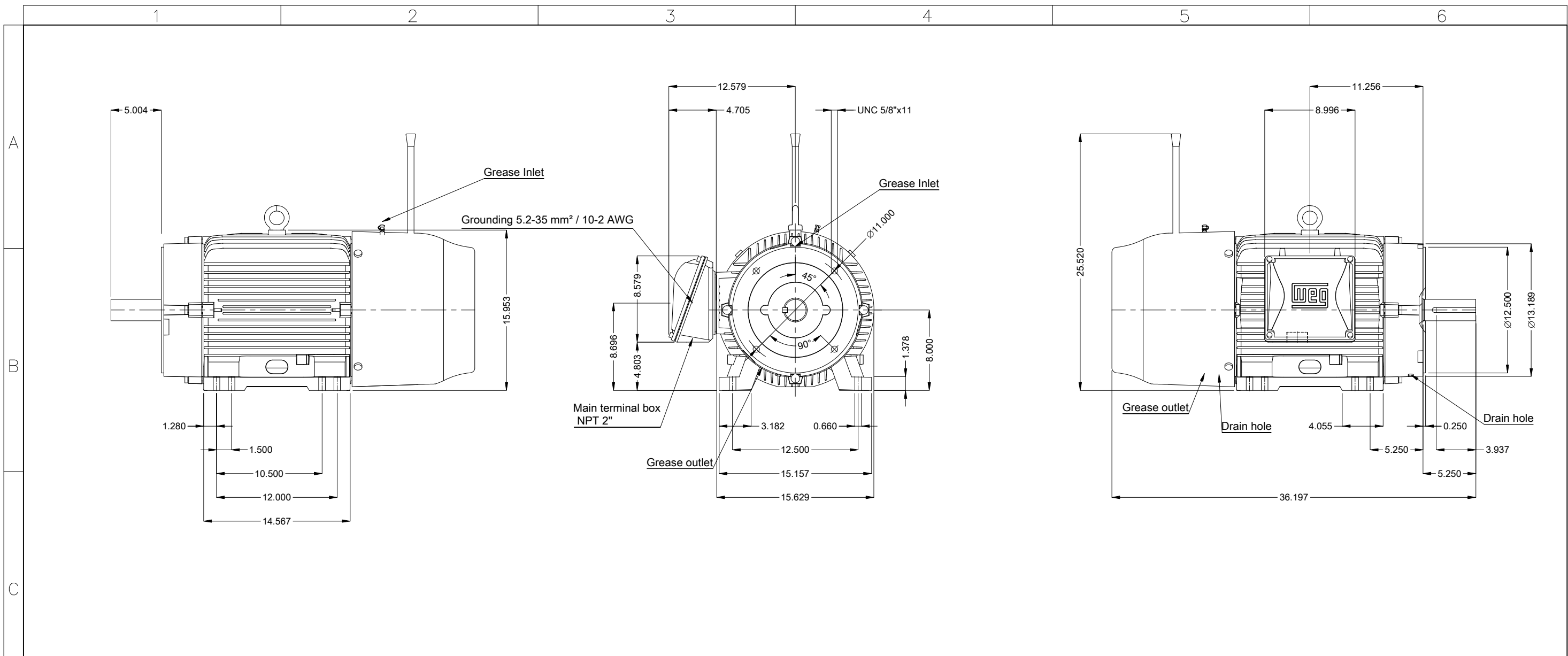

D					40 HP 04 Poles 60 Hz		A				
					Scale 1 : 10						
E	Break size 25 (400 Nm)	DE Shaft End 			HYBRISUSER		00				
	Brake voltage 525-575 V		ECM	LOC	SUMMARY OF MODIFICATIONS	EXECUTED	CHECKED	RELEASED	DATE	VER	
	Color RAL 5009		EXECUTED	HYBRISUSER	THREE PH. MOTOR W22 BRAKE MOTOR NEMA PREM. EFF.						
	Painting plan 203A		CHECKED		FRAME 324/6TC IP55 TEFC						
Mounting NEMA F-1	RELEASED										
Mounting B34D	REL. DATE										

Break size 25 (400 Nm)
Brake voltage 525-575 V
Color RAL 5009
Painting plan 203A
Mounting NEMA F-1
Mounting B34D



				HYBRISUSER		00	
ECM	LOC	SUMMARY OF MODIFICATIONS	EXECUTED	CHECKED	RELEASED	DATE	VER
EXECUTED	HYBRISUSER	THREE PH. MOTOR W22 BRAKE MOTOR NEMA PREM. EFF.					
CHECKED		FRAME 324/6TC IP55 TEFC					
RELEASED							
REL. DATE							

PREVIEW

WDD 00

SHEET 1 / 1