

DATA SHEET



Three Phase Induction Motor - Squirrel Cage

Customer :						
Product line		: W22 Brake Motor NEMA Premium Efficiency Three-Phase		Product code :		19198380
Frame	:	213/5T		Locked rotor time	:	102s (cold) 57s (hot)
Output	:	5 HP (3.7 kW)		Temperature rise	:	80 K
Frequency	:	60 Hz		Duty cycle	:	Cont.(S1)
Rated voltage	:	575 V		Ambient temperature	:	-20°C to +40°C
Poles	:	6		Altitude	:	1000 m.a.s.l.
Rated current	:	5.46 A		Protection degree	:	IP55
	:	6.8x(Code J)		Cooling method	:	IC411 - TEFC
Rated speed	:	1170 rpm		Mounting	:	F-1
Rated torque	:	3.10 kgfm		Rotation ¹	:	Both (CW and CCW)
Insulation class	:	F		Noise level ²	:	55.0 dB(A)
Service factor	:	1.25		Starting method	:	Direct On Line
Moment of inertia (J)	:	0.0620 kgm ²		Approx. weight ³	:	88.6 kg
Design	:	B				
Output	50%	75%	100%	Foundation loads		
Efficiency (%)	88.5	89.5	89.5	Max. traction	:	105 kgf
Power Factor	0.58	0.70	0.76	Max. compression	:	193 kgf
Losses at normative operating points (speed;torque), in percentage of rated output power						
P1 (0,9;1,0)	P2 (0,5;1,0)	P3 (0,25;1,0)	P4 (0,9;0,5)	P5 (0,5;0,5)	P6 (0,5;0,25)	P7 (0,25;0,25)
11.1	9.1	8.8	5.8	4.0	2.9	2.1
		<u>Drive end</u>		<u>Non drive end</u>		
Bearing type	:	6308 ZZ		6207 ZZ		
Sealing	:	V'Ring		Lip Seal		
Lubrication interval	:	-		-		
Lubricant amount	:	-		-		
Lubricant type	:		00088			
Notes						
This revision replaces and cancel the previous one, which must be eliminated. (1) Looking the motor from the shaft end. (2) Measured at 1m and with tolerance of +3dB(A). (3) Approximate weight subject to changes after manufacturing process. (4) At 100% of full load.				These are average values based on tests with sinusoidal power supply, subject to the tolerances stipulated in NEMA MG-1.		
Rev.	Changes Summary			Performed	Checked	Date
Performed by						
Checked by					Page	Revision
Date	12/05/2026				1 / 3	

DATA SHEET

Three Phase Induction Motor - Squirrel Cage



Customer : _____

Brake information

Voltage: 525-575 V
Brake Torque: 8.15 kgfm

Rev.	Changes Summary	Performed	Checked	Date
Performed by				
Checked by				
Date	12/05/2026		Page 2 / 3	Revision

LOAD PERFORMANCE CURVE

Three Phase Induction Motor - Squirrel Cage



Customer :

Product line : W22 Brake Motor NEMA Premium Efficiency Three-Phase Product code : 19198380

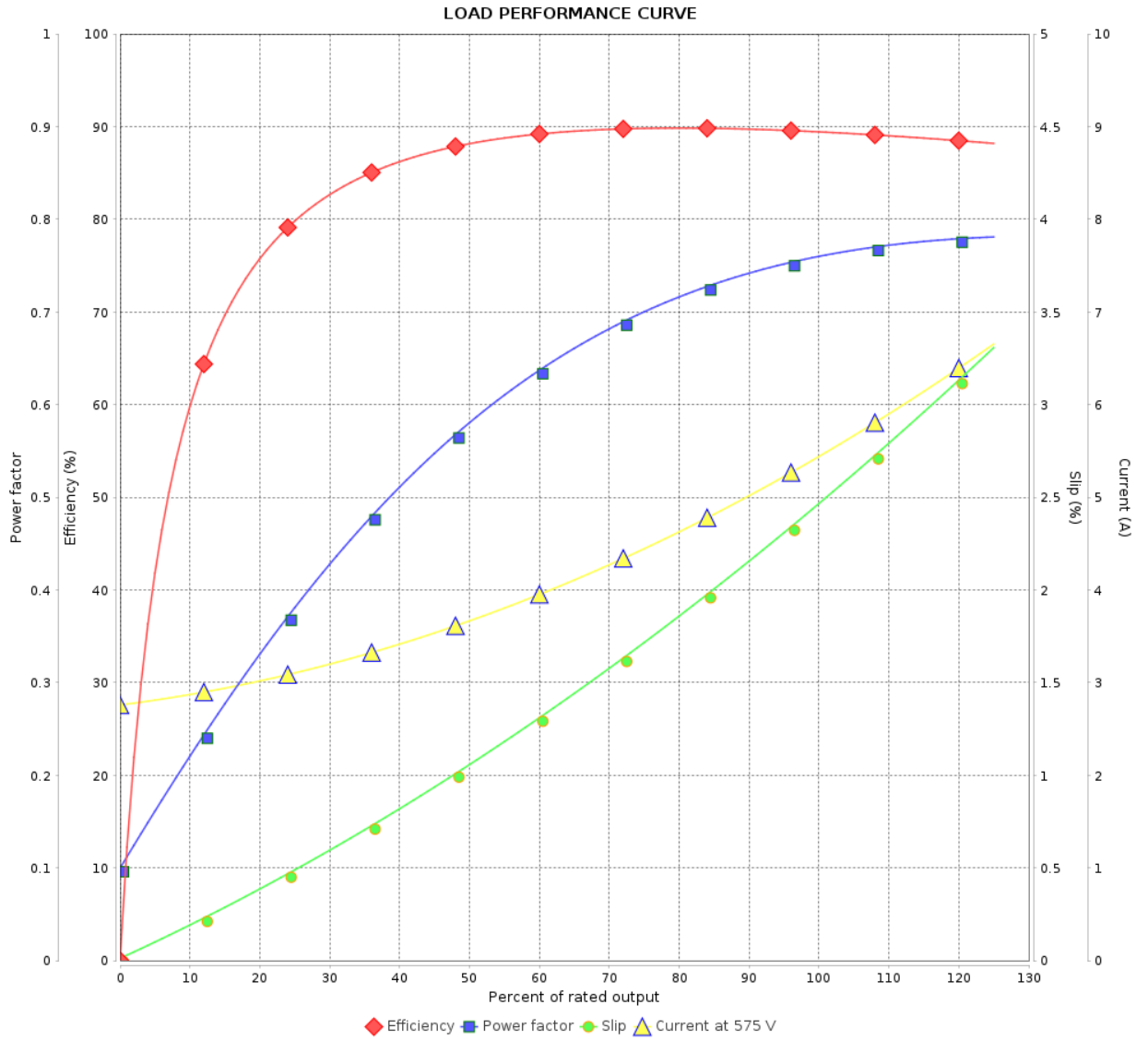

Rev.	Changes Summary	Performed	Checked	Date
Performed by		Page 3 / 3		Revision
Checked by				
Date				

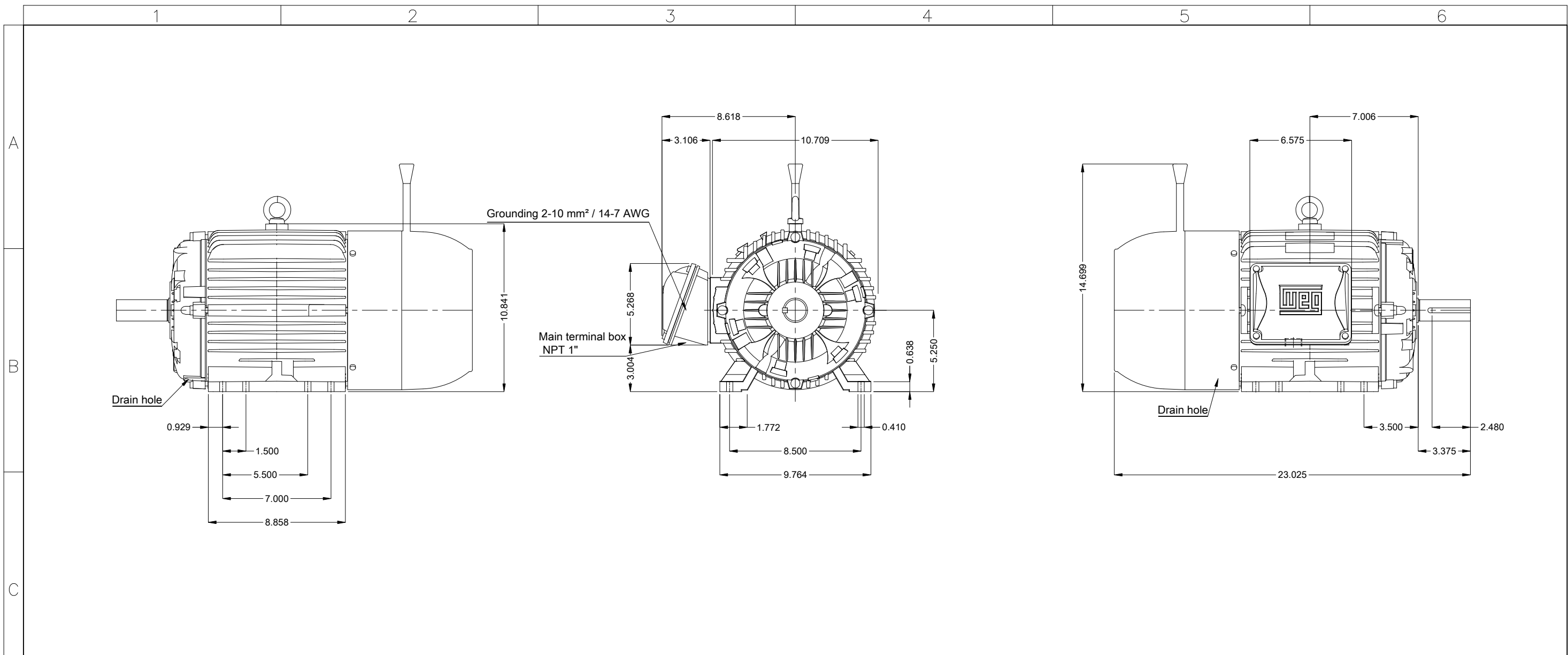

A

B

C

D

Break size 16 (80 Nm)
Brake voltage 525-575 V
Color RAL 5009
Painting plan 207A
Mounting NEMA F-1
Mounting B3R(D)

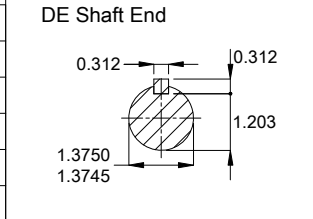

5 HP 06 Poles 60 Hz		A
Scale 2 : 13		
ECM	LOC	
EXECUTED	HYBRISUSER	
CHECKED		
RELEASED		
REL. DATE		

HYBRISUSER				00
EXECUTED	CHECKED	RELEASED	DATE	VER
EXECUTED	HYBRISUSER	THREE PH. MOTOR W22 BRAKE MOTOR NEMA PREM. EFF.		PREVIEW WDD 00 SHEET 1 / 1
CHECKED		FRAME 213/5T IP55 TEFC		
RELEASED				
REL. DATE				