

DATA SHEET



Single Phase Induction Motor - Squirrel Cage

Customer :					
Product line		: Rolled Steel Grain Dryer Single-Phase		Product code : 13972899	
Frame	:	213/5TZ	Locked rotor time	: 14s (cold) 8s (hot)	
Output	:	10 HP (7.5 kW)	Temperature rise	: 105 K	
Frequency	:	60 Hz	Duty cycle	: Cont.(S1)	
Rated voltage	:	230 V	Ambient temperature	: -20°C to +40°C	
Poles	:	2	Altitude	: 1000 m.a.s.l.	
Rated current	:	38.2 A	Protection degree	: IP55	
	:	10.7x(Code L)	Cooling method	: IC418 - TEAO	
Rated speed	:	3550 rpm	Mounting	: F-3	
Rated torque	:	2.04 kgfm	Rotation ¹	: Both (CW and CCW)	
Insulation class	:	F	Noise level ²	: 75.0 dB(A)	
Service factor	:	1.00	Starting method	: Direct On Line	
			Approx. weight ³	: 82.2 kg	
Output	25%	50%	75%	100%	
Efficiency (%)	80.5	82.2	86.4	88.0	
Power Factor	0.70	0.95	0.96	0.97	
Foundation loads					
Max. traction : 125 kgf					
Max. compression : 207 kgf					
		<u>Drive end</u>	<u>Non drive end</u>		
Bearing type	:	6208 ZZ	6206 ZZ		
Sealing	:	V'Ring	Without Bearing Seal		
Lubrication interval	:	-	-		
Lubricant amount	:	-	-		
Lubricant type	:	Mobil Polyrex EM			
Notes					
This revision replaces and cancel the previous one, which must be eliminated. (1) Looking the motor from the shaft end. (2) Measured at 1m and with tolerance of +3dB(A). (3) Approximate weight subject to changes after manufacturing process. (4) At 100% of full load.			These are average values based on tests with sinusoidal power supply, subject to the tolerances stipulated in NEMA MG-1.		
Rev.	Changes Summary		Performed	Checked	Date
Performed by					
Checked by				Page	Revision
Date	12/05/2026			1 / 3	

DATA SHEET

Single Phase Induction Motor - Squirrel Cage



Customer : _____

Thermal protection

ID	Application	Type	Quantity	Sensing Temperature
1	Winding	Thermostat - 2 wires	1 x Phase	155 °C

Rev.	Changes Summary	Performed	Checked	Date
Performed by		Page 2 / 3		Revision
Checked by				
Date	12/05/2026			

LOAD PERFORMANCE CURVE

Single Phase Induction Motor - Squirrel Cage



Customer : _____

Product line : Rolled Steel Grain Dryer Single-Phase

Product code : 13972899

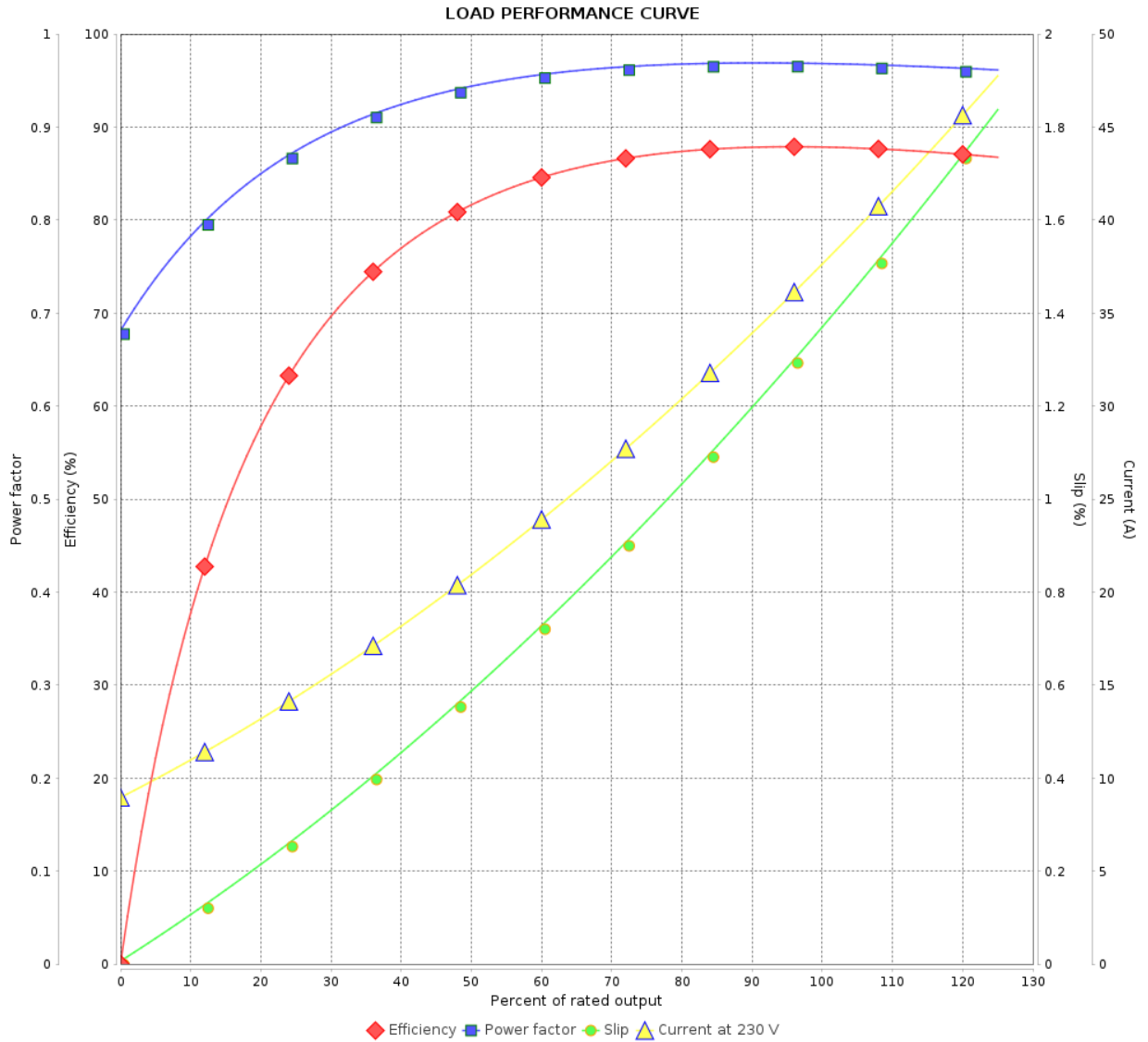

Rev.	Changes Summary	Performed	Checked	Date
Performed by		Page 3 / 3		Revision
Checked by				
Date				

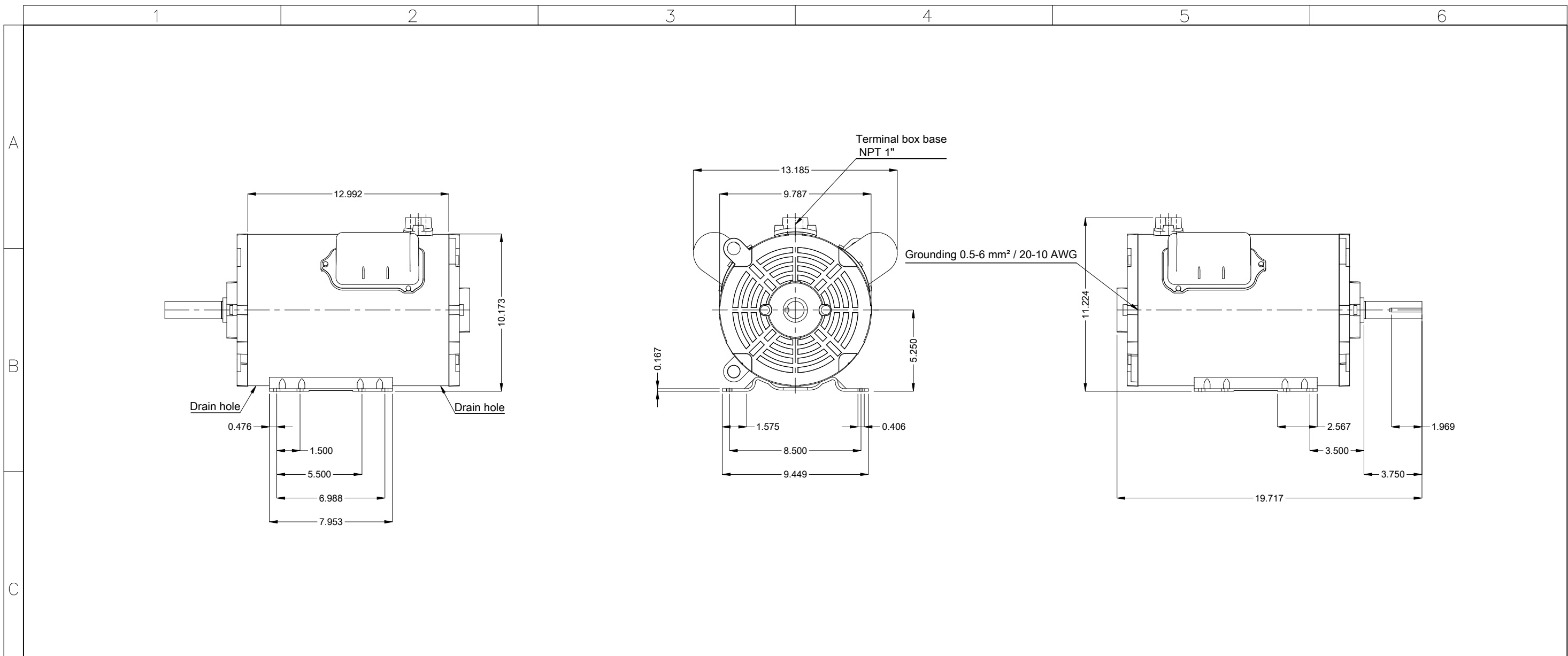

Mounting MARKET F-3/B3T
 Mounting B3T

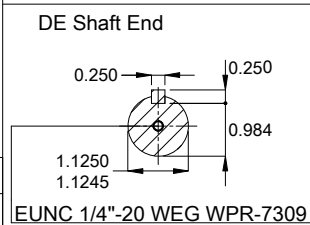

10-15 HP 02 Poles 60 Hz										A	
Scale										2 : 13	
HYBRISUSER										00	
ECM	LOC	SUMMARY OF MODIFICATIONS					EXECUTED	CHECKED	RELEASED	DATE	VER
EXECUTED	HYBRISUSER	SINGLE PH. MOTOR ROLLED STEEL GRAIN DRYER FRAME 213/5TZ IP55 TEAO					PREVIEW				
CHECKED							WDD				00
RELEASED							SHEET				1 / 1
REL. DATE											