

A

B

C

D

E

NPT 1 1/2"

Grounding for leads 5.2-25 mm² / 10-4 AWG

20 HP 02 Poles 60 Hz A

Certification UL/FIRE PUMP

Color RAL 5009

Painting plan 203A

Mounting NEMA F-1

Mounting B34D

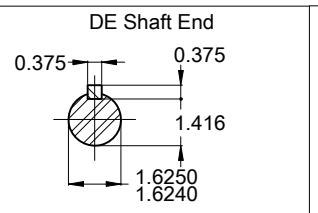

ECM	LOC	SUMMARY OF MODIFICATIONS	EXECUTED	CHECKED	RELEASED	DATE	VER
EXECUTED	HYBRISUSER	THREE PH. MOTOR GENERAL HIGH EFF.					00
CHECKED		FRAME 254TC IP23 ODP					
RELEASED							
REL. DATE		WMO Jaragua do Sul					

**PREVIEW**

WDD 00

SHEET 1 / 1